

| LEGEND | |
|-----------------|---------------------------------|
| X X X X X X X X | CURB REMOVAL |
| XXXXXX | SIDEWALK REMOVAL |
| XXXXXX | ASPHALT REMOVAL |
| XXXXXX | CONC. REMOVAL |
| XXXXXX | FENCE & GUARDRAIL REMOVAL |
| XXXXXX | EXISTING STORM REMOVAL |
| XXXXXX | EXISTING TRAFFIC SIGNAL REMOVAL |
| X X X X X X X X | EXISTING SIGN REMOVAL |
| X X X X X X X X | EXISTING TREE REMOVAL |
| X X X X X X X X | EXISTING LIGHT POLE REMOVAL |
| X X X X X X X X | EXISTING POWER POLE REMOVAL |
| X X X X X X X X | EXISTING TRAFFIC CONTROL BOX |
| X X X X X X X X | EXISTING BOLLARD REMOVAL |

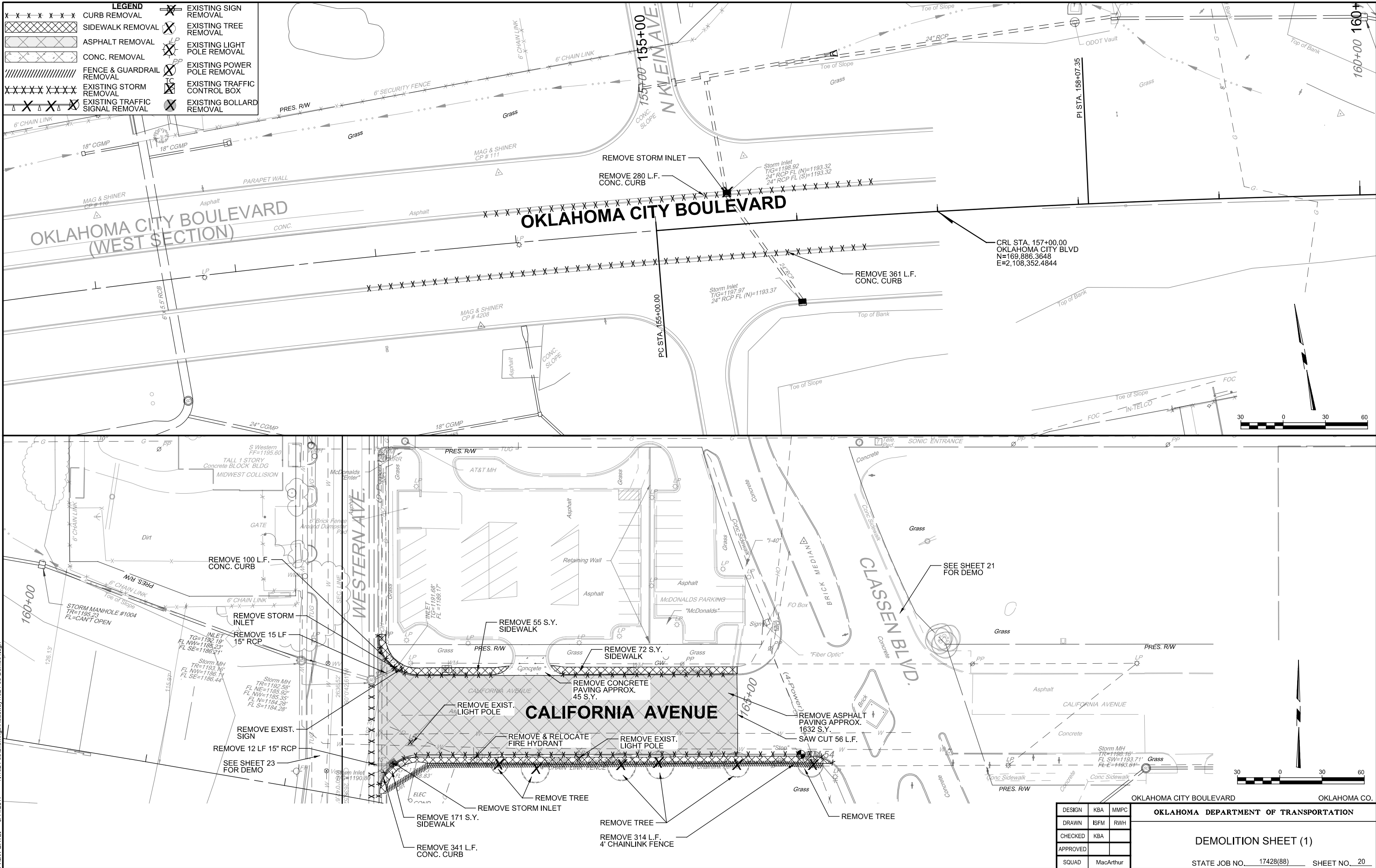

CRL STA. 157+00.00
 OKLAHOMA CITY BLVD
 N=169,886.3648
 E=2,108,352.4844



| | | |
|----------|-----------|------|
| DESIGN | KBA | MMPC |
| DRAWN | ISFM | RWH |
| CHECKED | KBA | |
| APPROVED | | |
| SQUAD | MacArthur | |

OKLAHOMA DEPARTMENT OF TRANSPORTATION

DEMOLITION SHEET (1)

STATE JOB NO. 17428(88) SHEET NO. 20

PRINT DATE: 9/11/2017 T:\1024-05\Drawings\Roadway\1024-05-Demo01.dgn